



NOTES:

COURSE HAS BEEN MEASURED IN ACCORDANCE WITH USATF/RRTC REQUIREMENTS, USING THE SHORTEST POSSIBLE ROUTE (SPR) METHOD, TO WITHIN 12" OF ALL CURBS AND ROAD EDGES AND, WHERE WITHIN THE PAVED PARKING LOT, ON PATH DEFINED BY PAINTED ARROWS.

- FULL WIDTH OF ROADS WILL BE AVAILABLE TO RUNNERS EXCEPT:
1. RUNNERS ARE RESTRICTED TO THE NORTHWEST SIDE OF S YORK ROAD
 2. RUNNERS ARE RESTRICTED TO THE SIDEWALK ON THE SOUTHWEST SIDE OF BLAIR MILL ROAD

ELEVATIONS ARE RELATIVE AND ARE TAKEN FROM GOOGLE EARTH IMAGING

SKELETON SCURRY 5K Hatboro, PA

USATF/RRTC
Certification Code:
PA10022WB
 Effective: 06/28/10 to 12/31/2020

ELEVATIONS:	
START:	205 FT
FINISH:	204 FT
HIGHEST:	284 FT
LOWEST:	204 FT

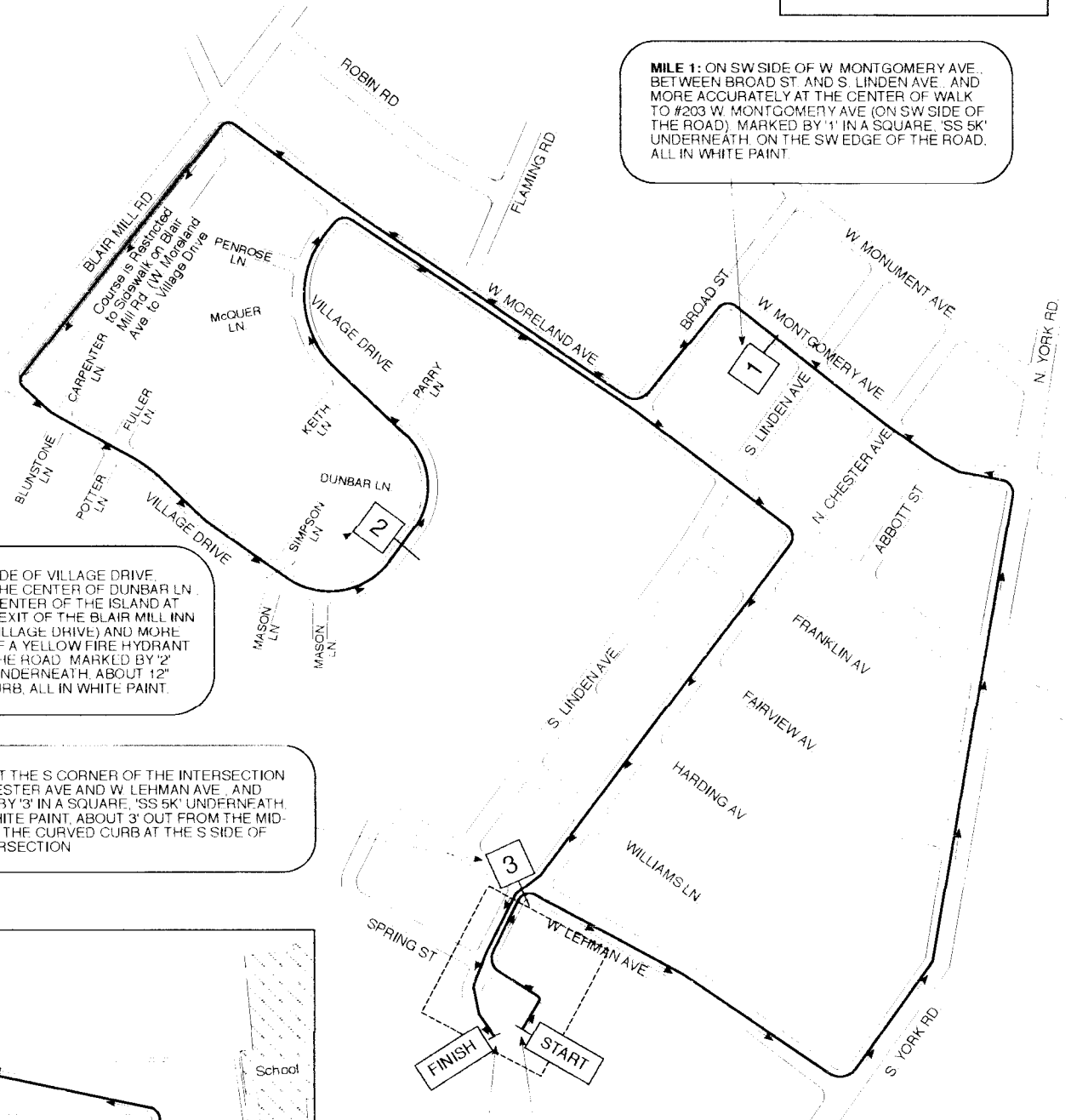

MILE 1: ON SW SIDE OF W MONTGOMERY AVE, BETWEEN BROAD ST AND S LINDEN AVE, AND MORE ACCURATELY AT THE CENTER OF WALK TO #203 W MONTGOMERY AVE (ON SW SIDE OF THE ROAD), MARKED BY '1' IN A SQUARE, 'SS 5K' UNDERNEATH, ON THE SW EDGE OF THE ROAD. ALL IN WHITE PAINT.

MILE 2: ON THE NW SIDE OF VILLAGE DRIVE, APPROX. 470' SW OF THE CENTER OF DUNBAR LN AND 104' SW OF THE CENTER OF THE ISLAND AT THE DUAL ENTRANCE/EXIT OF THE BLAIR MILL INN (ON THE SE SIDE OF VILLAGE DRIVE) AND MORE ACCURATELY 35' NE OF A YELLOW FIRE HYDRANT ON THE NW SIDE OF THE ROAD, MARKED BY '2' IN A SQUARE, 'SS 5K' UNDERNEATH, ABOUT 12' OUT FROM THE NW CURB, ALL IN WHITE PAINT.

MILE 3: AT THE S CORNER OF THE INTERSECTION OF S CHESTER AVE AND W LEHMAN AVE, AND MARKED BY '3' IN A SQUARE, 'SS 5K' UNDERNEATH, ALL IN WHITE PAINT, ABOUT 3' OUT FROM THE MID-POINT OF THE CURVED CURB AT THE S SIDE OF THE INTERSECTION

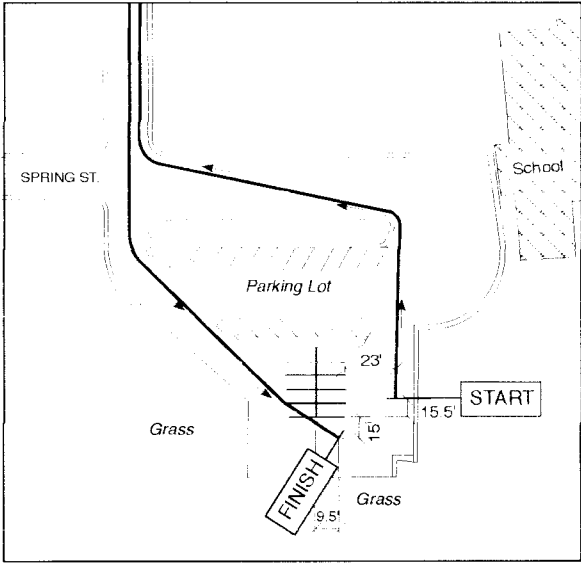

START: IN THE SOUTH END OF PARKING LOT OF THE ELEMENTARY SCHOOL, MARKED BY 'S' IN A SQUARE, 'SS 5K' UNDERNEATH, ALL IN WHITE PAINT. MARK IS 15.5' NE OF THE YELLOW REAR STRIPE OF THE GROUP OF 10 PARKING SPOTS, AND 23' SE OF THE OUTER ENDS OF THE PARKING LOT STRIPES (AS SHOWN IN THE DETAIL INSET).

FINISH: IN THE SOUTH END OF PARKING LOT OF THE ELEMENTARY SCHOOL, MARKED BY 'F' IN A SQUARE, 'SS 5K' UNDERNEATH, ALL IN WHITE PAINT. MARK IS 9.5' SE OF THE CENTER DIVIDING STRIPE IN THE CENTER OF THE GROUP OF 10 PARKING SPACES (SHOWN IN THE DETAIL INSET ON THE LEFT) AND 15' SW OF THE YELLOW STRIPE MARKING THE TWO PARKING SPACES AT THE SW END OF THE GROUP OF TEN SPACES

BILL BELLEVILLE
 ARDMORE, PA
 JUNE 2010
 CS-1034