



ELEVATIONS	
START	124 FT
FINISH	124 FT
HIGHEST	124 FT
LOWEST	118 FT

USATF/RRTC
 Certification Code
NJ10001WB
 Effective 04/05/2010 to 12/31/2020

5K BEE LINE DASH

Tall Pines Day Camp

Williamstown, NJ

DESCRIPTION OF ROUTE:

SEGMENTS A & B:

- START IS EVEN WITH THE TWIN TOTEM POLES AT THE ENTRANCE ROAD TO THE DAY CAMP. COURSE GOES SE ON THE GRAVEL ROAD, FOLLOWING IT AROUND CLOCKWISE TO GO N, PASSING THE PEDAL KART BLDG, THEN TURNING LEFT (W) INTO THE OPENING IN THE WOODS. TO GO CLOCKWISE AROUND THE FOUR WHITE PVC POSTS MARKING THE PERIMETER OF THE LEACHING FIELD, AND CONTINUING EAST ON A LINE 6' TO THE RIGHT OF THE HIGH WIRE FENCE TO PVC SLEEVE #1 SET IN THE GROUND (6' OUT FROM THE FENCE AND OPPOSITE THE 2ND 9' HIGH CEDAR PINE POST WEST OF THE STREAM).
 - CLOCKWISE AROUND PVC SLEEVE #1 ALONG THE EDGE OF THE WOODS, TO PVC SLEEVE #2.
 - VEER LEFT AROUND PVC SLEEVE #2 TO GO DIRECTLY TOWARD THE END POLE OF THE HIGH GOLF FENCING.
 - CLOCKWISE AROUND THIS END POLE, GOING ON THE LAKE SIDE OF THE FENCING, TO THE OPPOSITE END POLE.
 - CLOCKWISE AROUND THIS END POLE TO A POINT 6' SW OF THE END POST OF THE CHAIN LINK FENCE.
 - LEFT (CCW) 6' OUT FROM THE FENCE, ON A LINE TO GO DIRECTLY THRU THE 4' WIDE SPACE BETWEEN THE BASE OF THE GUY WIRES TO THE RIGHT AND A PICNIC TABLE ON THE LEFT, AND PASSING TO THE RIGHT OF UTILITY POLE #17788, AND THEN COUNTERCLOCKWISE AROUND THE LAST TREE AT THE EAST SIDE OF THE GRAVEL ROAD.
 - TURN LEFT (CCW) TO RETURN TO THE GRAVEL ROAD, FOLLOWING IT AROUND TO THE LEFT TO A POINT TO MAKE A RIGHT TURN TO THE SOUTH TO GO ON A LINE BETWEEN THE LEFT (EAST) SIDE OF A SINGLE TREE AND THE WEST SIDE OF THE PAVILION, TOWARD A MANHOLE COVER IN THE TOP OF A 5' DIAM. CONCRETE PAD.
 - TURN RIGHT (CW) AROUND THE CONCRETE PAD TO GO WEST TOWARD PVC SLEEVE #3 (LOCATED 15' EAST OF AN 8" DIAM. TREE).
 - TURN LEFT (CCW) AROUND SLEEVE #3 ABOUT 45 DEG TO GO SOUTHWEST TOWARD THE FAR CORNER POST AT THE REAR OF THE BACKSTOP.
 - TURN RIGHT (CW) AROUND THE BACKSTOP CORNER, TOWARD PVC SLEEVE #4 (LOCATED ABOUT 8' OUT FROM THE CORNER OF THE WOODS).
 - TURN RIGHT (CW) AROUND SLEEVE #4 TO GO NORTH ALONG THE EDGE OF THE WOODS TO ENTER THE NARROW PASSAGEWAY THROUGH THE TREES.
 - VEER LEFT THROUGH THE OPENING IN THE TREES, OVER A BRIDGE OVER A CREEK, TO THEN TURN LEFT TO THE WEST, TOWARD SLEEVE #5.
 - TURN RIGHT (CW) AROUND SLEEVE #5 TO GO NORTH ACROSS THE SOCCER FIELD, DIRECTLY TOWARD A 30" HIGH BLUE PIPE MARKER.
 - TURN RIGHT (CW) AROUND THE BLUE PIPE TO GO EAST TO MERGE ONTO THE GRAVEL ROAD, FOLLOWING IT EAST TO MAKE A RIGHT TURN.
 - GO SOUTH ON THE MAIN GRAVEL ROAD, FOLLOWING IT AROUND TO THE LEFT, THEN NORTHEAST TOWARD THE START, BUT TURNING CLOCKWISE (JUST BEFORE THE PARKING LOT) ON THE INTERIOR GRAVEL ROAD TO GO SOUTHWEST, TO START A SECOND SEGMENT (SHOWN BY WHITE ARROW HEADS), MAKING A RIGHT TURN AROUND THE REST ROOMS, TO REJOIN THE MAIN GRAVEL ROAD, THEN TURN COUNTERCLOCKWISE AT THE EAST END TO REPEAT THE ROUTE DESCRIBED ABOVE FOR SECOND SEGMENT.
 - NEAR THE END OF THE SECOND SEGMENT LOOP THE COURSE LEAVES THE MAIN GRAVEL ROAD, TURNING CLOCKWISE AROUND THE LEFT SIDE OF THE LONE TREE AS BEFORE, BUT TURNING RIGHT A LITTLE MORE TO HEAD DIRECTLY TOWARD THE END POST OF THE CHAIN LINK FENCING ALONG THE 3RD BASE LINE OF THE FIELD 'B'.
 - GO EAST ALONG THE RIGHT (S) SIDE OF THE BACKSTOP DIRECTLY TOWARD THE GRASS OPENING BETWEEN THE POOL (ON THE RIGHT) AND THE TIMBER PLANTING FRAMES ON THE LEFT.
 - TURN LEFT (NORTH) AROUND THE EASTERNMOST PAIR OF TIMBER PLANTING FRAMES AND GO NORTH ON THE SIDEWALK (OPPOSITE THE ENTRANCE GATE TO THE POOL) TOWARD THE MAIN GRAVEL ROAD.
 - TURN RIGHT (CW) AROUND THE REST ROOM BLDG. TO GO EAST ON THE MAIN GRAVEL ROAD, TOWARD THE START BUT TURNING CLOCKWISE (JUST BEFORE THE PARKING LOT) ON THE INTERIOR GRAVEL ROAD TO GO SW, PASSING THE OFFICE BLDG., AND TO THE FINISH.
- THE FINISH IS LOCATED ON THE INTERIOR GRAVEL ROAD, 63' WEST OF THE WEST EDGE OF THE OPEN DECK ON THE WEST SIDE OF THE OFFICE. THE FINISH IS ALSO LOCATED 12' WEST OF THE CENTER OF THE DOOR TO THE ARTS & CRAFTS SHOP (ON THE NORTH SIDE OF THE INTERIOR GRAVEL ROAD).

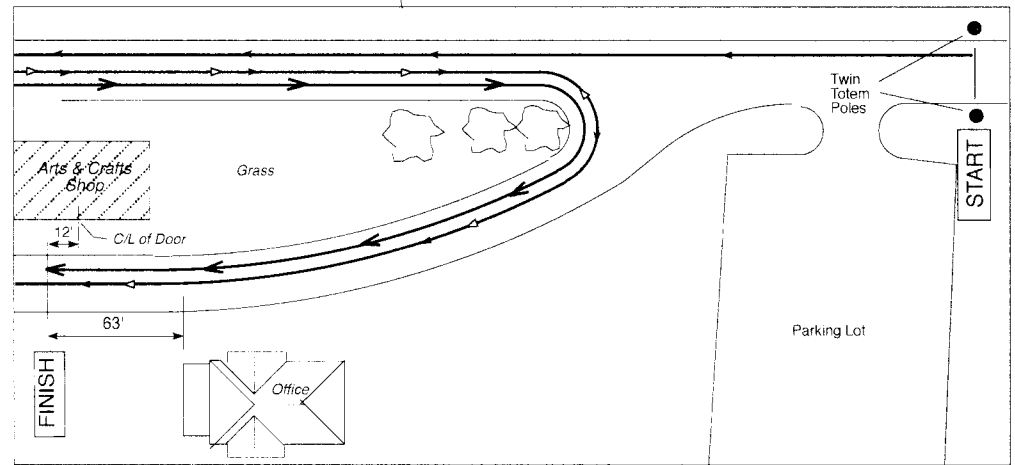
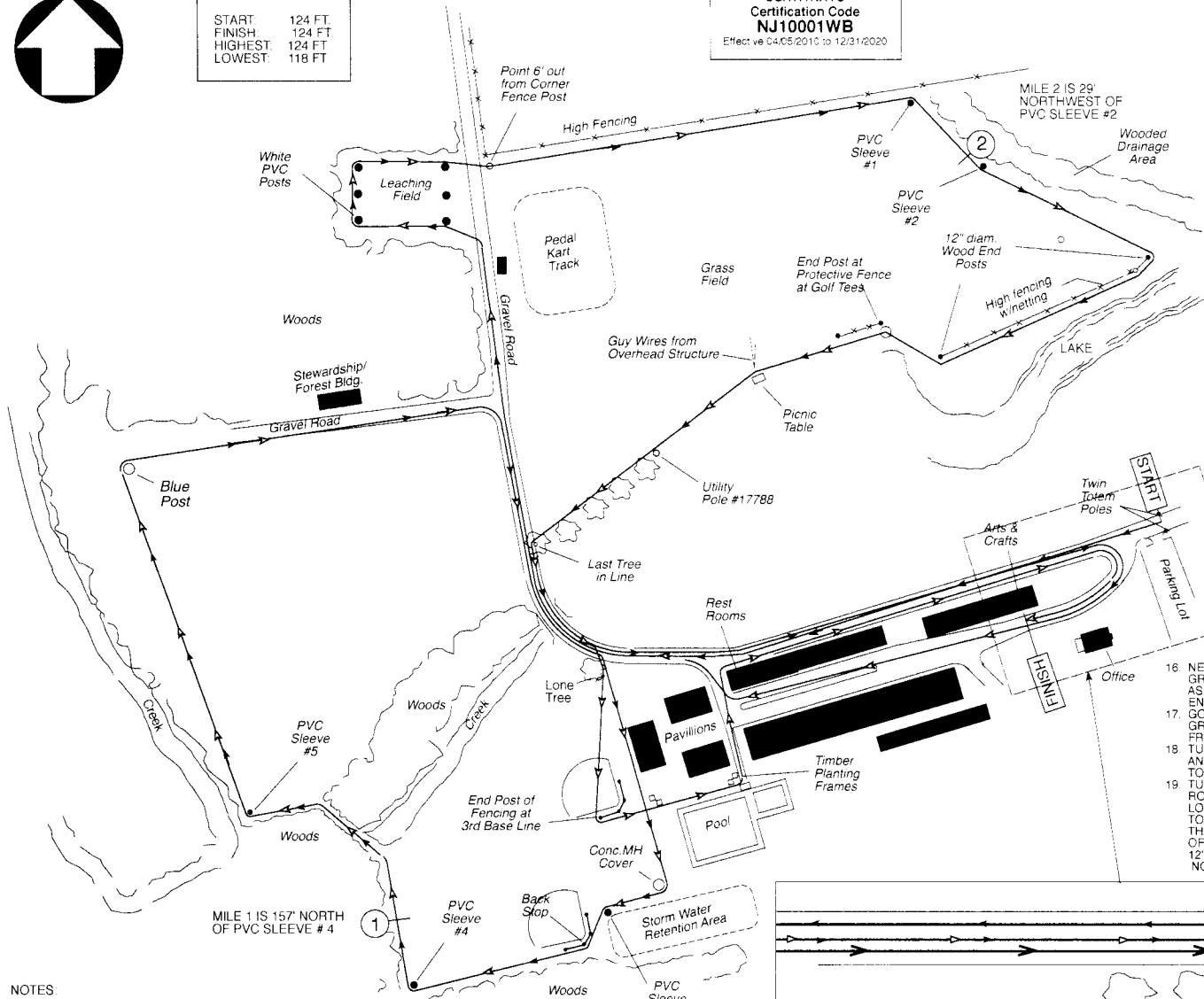

NOTES:
 COURSE HAS BEEN MEASURED IN ACCORDANCE WITH USATF/RRTC REQUIREMENTS, USING THE SHORTEST POSSIBLE ROUTE (SPR) METHOD, TO WITHIN 1/2" OF DEFINED ROAD AND PATH EDGES, AND TO 12" FROM ALL INDICATED TURNING SLEEVES, FENCE POSTS AND PHYSICAL MARKERS.

COURSE CONSISTS OF TWO SEGMENTS (LOOPS). THE FIRST SEGMENT IS INDICATED ON THIS MAP BY SOLID BLACK ARROWHEADS (→) THE SECOND SEGMENT IS INDICATED BY HOLLOW WHITE ARROWHEADS (- - - →)

ELEVATIONS INDICATED ARE AS OBSERVED USING GOOGLE EARTH IMAGING